

## Service Tools

### Tools for the assembly of seals



#### Advantages

- Optimally suitable special tools for the assembly and disassembly of seals for hydraulic elements

#### Tools

- Picker set 5
- Calibration sleeves for external seals
- Calibration mandrels for internal seals

#### Picker set 5



Picker set for seal disassembly, contains 5 special tools in an envelope bag. With these differently shaped, hook-shaped tools, seals can be removed from the sealing grooves. The tools are specially rounded at the tip to protect the seals.

**Part no. 9001900**

#### Calibration sleeves for external seals

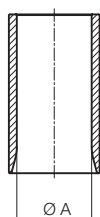

Precisely fitting sleeves for the corresponding exterior diameter with special inlet beaks for calibrating newly mounted external seals. The tool is used to return previously expanded seals to their original seal diameter. When assembling the hydraulic element, the calibration sleeve prevents subsequent assembly damage caused by seals protruding from the groove.

Ø A [mm]	Part no.	Ø A [mm]	Part no.
10	<b>9001 100</b>	32	<b>9001 112</b>
12	<b>9001 127</b>	33	<b>9001 142</b>
14	<b>9001 130</b>	35	<b>9001 145</b>
16	<b>9001 103</b>	40	<b>9001 115</b>
20	<b>9001 106</b>	50	<b>9001 118</b>
23	<b>9001 133</b>	52	<b>9001 148</b>
25	<b>9001 109</b>	56	<b>9001 151</b>
26	<b>9001 136</b>	63	<b>9001 121</b>
28	<b>9001 139</b>		

## SERVICE Tools

### Tools for the assembly of seals

#### Changeable calibration mandrels for internal seals

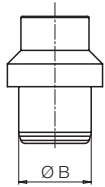

#### Combination tool for seal and wiper assembly

Precisely fitting mandrel for the corresponding interior diameter with special inlet beaks for calibrating newly mounted interior seals. The tool is used to return seals previously expanded for assembly to their original seal diameter. This process prevents subsequent sealing or assembly damage caused by seals protruding from the groove during the assembly of the hydraulic element.

A special stop surface is available for the assembly of a wiper which must be pressed into the groove on the element head. With this surface, the wiper can be safely inserted into the groove.

#### Attention:

Can only be used in combination with the holder for changeable calibration mandrels. The holder is needed only once and fits for all changeable calibration mandrels.

Ø B [mm]	Part no.	Ø B [mm]	Part no.
10	<b>9001 203</b>	32	<b>9001 215</b>
16	<b>9001 206</b>	40	<b>9001 218</b>
20	<b>9001 209</b>	50	<b>9001 224</b>
25	<b>9001 212</b>	63	<b>9001 227</b>

#### Holder for changeable calibration mandrels



#### Holder for sealing and wiper tool

The basic tool for setting the wipers is required as a basic tool for every changeable calibration mandrel. Suitable for all changeable calibration mandrels.

**Part no. 9001 200**

#### Hydraulic tool case "Comfort 31"



#### Calibration and assembly tools:

**17 calibration sleeves, 8 exchangeable calibration mandrels plus holder, Picker set 5, instructions**

**Part no. 9001 940**

#### Content:

##### 1. Calibration sleeves for piston seals

1 x size 10 - Part no. 9001 100	1 x size 32 - Part no. 9001 112
1 x size 12 - Part no. 9001 127	1 x size 33 - Part no. 9001 142
1 x size 14 - Part no. 9001 130	1 x size 35 - Part no. 9001 145
1 x size 16 - Part no. 9001 103	1 x size 40 - Part no. 9001 115
1 x size 20 - Part no. 9001 106	1 x size 50 - Part no. 9001 118
1 x size 23 - Part no. 9001 133	1 x size 52 - Part no. 9001 148
1 x size 25 - Part no. 9001 109	1 x size 56 - Part no. 9001 151
1 x size 26 - Part no. 9001 136	1 x size 63 - Part no. 9001 121
1 x size 28 - Part no. 9001 139	

##### 2. Holder for changeable calibration mandrels **Part no. 9001 200**

##### 3. Changeable calibration mandrels

1 x size 10 - Part no. 9001 203	1 x size 32 - Part no. 9001 215
1 x size 16 - Part no. 9001 206	1 x size 40 - Part no. 9001 218
1 x size 20 - Part no. 9001 209	1 x size 50 - Part no. 9001 224
1 x size 25 - Part no. 9001 212	1 x size 63 - Part no. 9001 227

##### 4. Picker set 5 **Part no. 9001 900**